

INDUSTRY PVC-U BALL VALVE



Size : DN 1/2" to 2"
Ends : Female / Female BSP or glued ends
Min Temperature : + 0°C
Max Temperature : + 60°C
Max Pressure : 16 Bars (up to DN 1"1/2 for threaded type)
Specifications : 3 pieces type
Double FPM o ring on stem
Full bore for Ref.599

Materials : PVC-U

INDUSTRY PVC-U BALL VALVE

SPECIFICATIONS :

- Respect the flow direction indicated by the arrow
- 3 pieces type
- Double FPM o ring on stem
- Full bore for Ref.599
- PP handle

USE :

- For all common fluids
- Δp maxi : 3 bars
- Min Temperature Ts : + 0 °C
- Max Temperature Ts : + 60°C
- Max Pressure PN : 16 bars for valve with glued ends Ref. 598 (see graph under)
- Max Pressure PN : 16 bars up DN 1"1/2, 10 bars over for valve with threaded ends Ref.599

PRESSURE / TEMPERATURE GRAPH (STEAM EXCLUDED) :

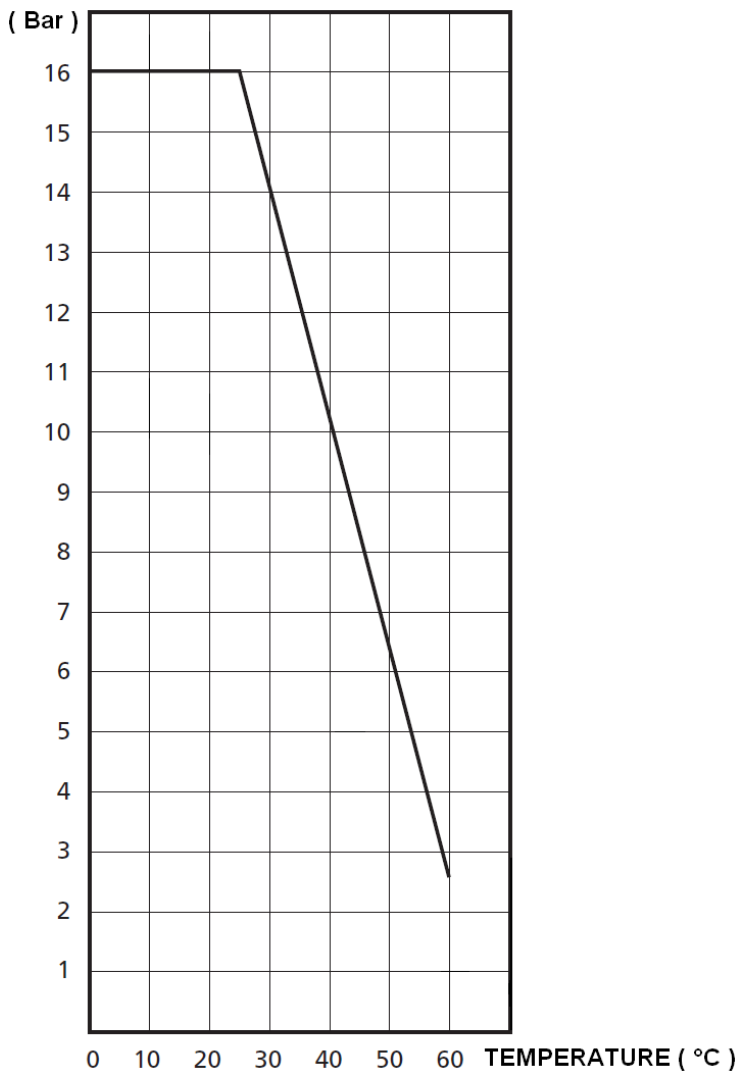

INDUSTRY PVC-U BALL VALVE
RANGE :

- With glued ends **Ref. 598** from DN15/20 to 50/63
- With Female / Female BSP threaded ends **Ref. 599** from DN 1/2" to 2"

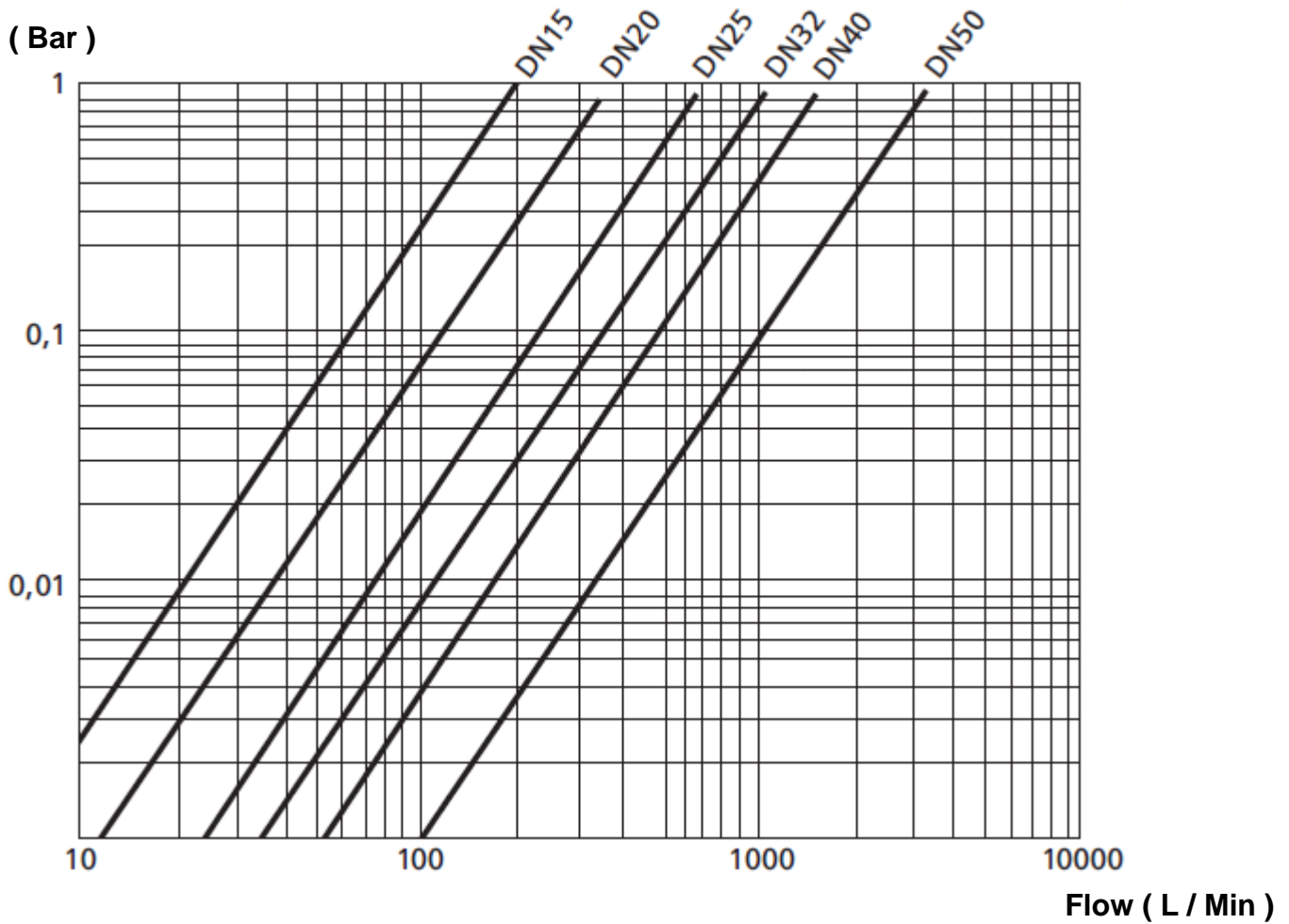
HEAD LOSS GRAPH :

TORQUE VALUES (in Nm without safety coefficient) :

DN Ref.598	15/20	20/25	25/32	32/40	40/50	50/63
DN Ref.599	1/2"	3/4"	1"	1"1/4	1"1/2	2"
Torque (Nm)	3	3	6	7	12	18

INDUSTRY PVC-U BALL VALVE

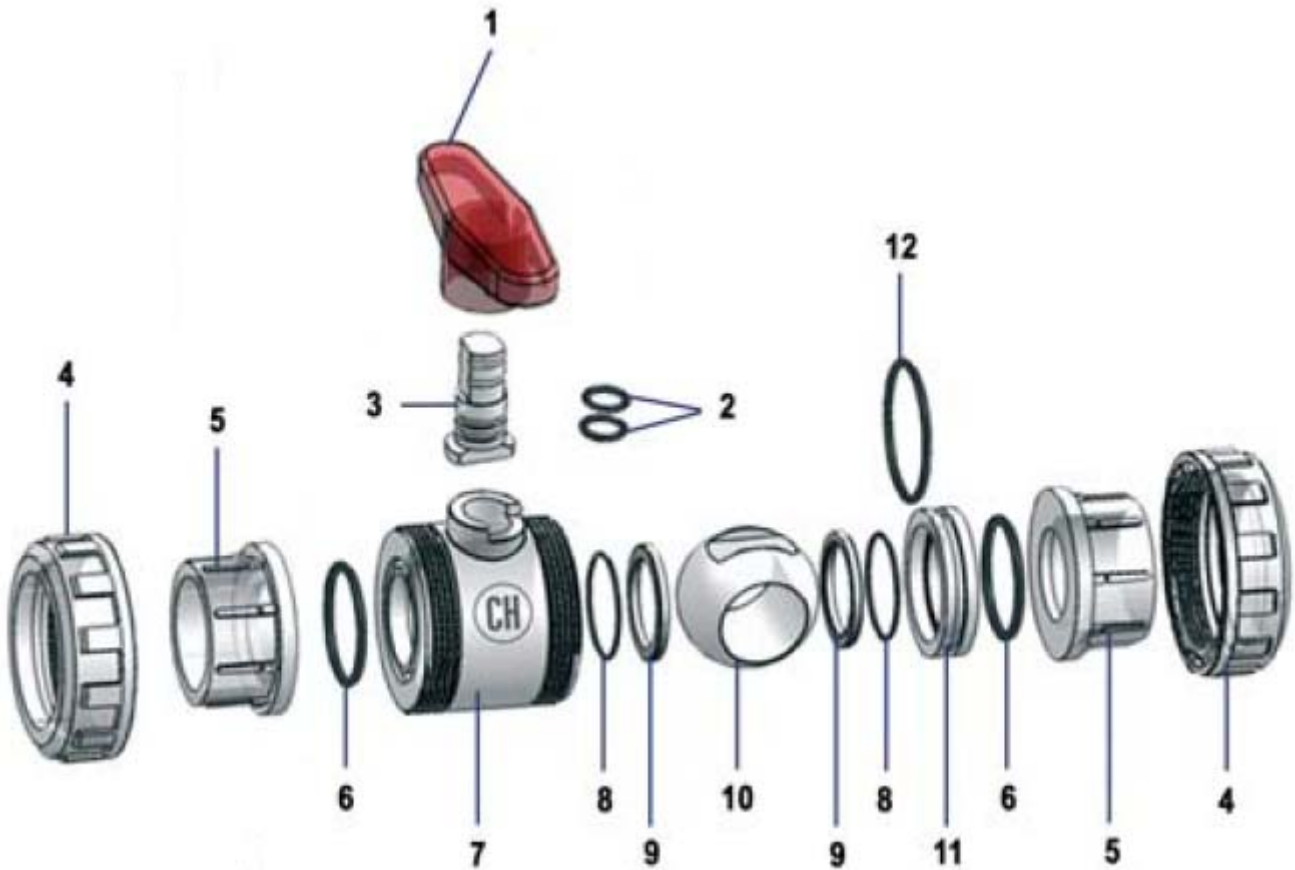
MATERIALS :



Item	Designation	Materials
1	Handle	PP
2	Stem o ring	FPM
3	Stem	PVC-U
4	Nut	PVC-U
5	Nipple	PVC-U
6	Body gasket	FPM
7	Body	PVC-U
8	Closing gasket	FPM
9	Ball gasket	PTFE
10	Ball	PVC-U
11	Ring	PVC-U
12	Ring gasket	FPM

INDUSTRY PVC-U BALL VALVE

SIZE WITH GLUED ENDS (in mm) :

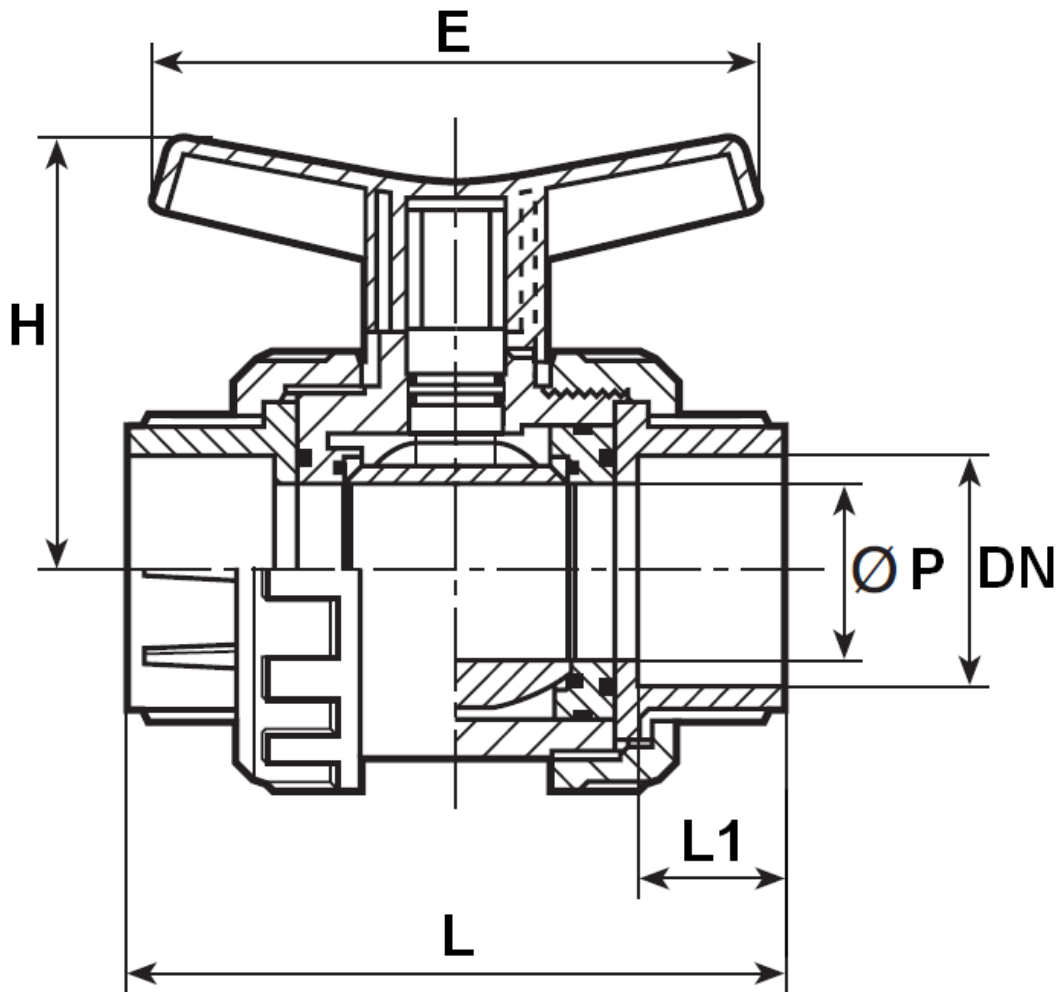

Ref.	DN	20	25	32	40	50	63
598	Ø P	15	20	25	32	40	50
	L	94.5	102	115	130	144	166
	L1	16	19	22	26	31	38
	E	85	85	99	99	128	128
	H	50.5	53	63	69	85	94
	Weight (Kg)	0.153	0.208	0.318	0.484	0.777	1.069

INDUSTRY PVC-U BALL VALVE

SIZE WITH THREADED ENDS (in mm) :

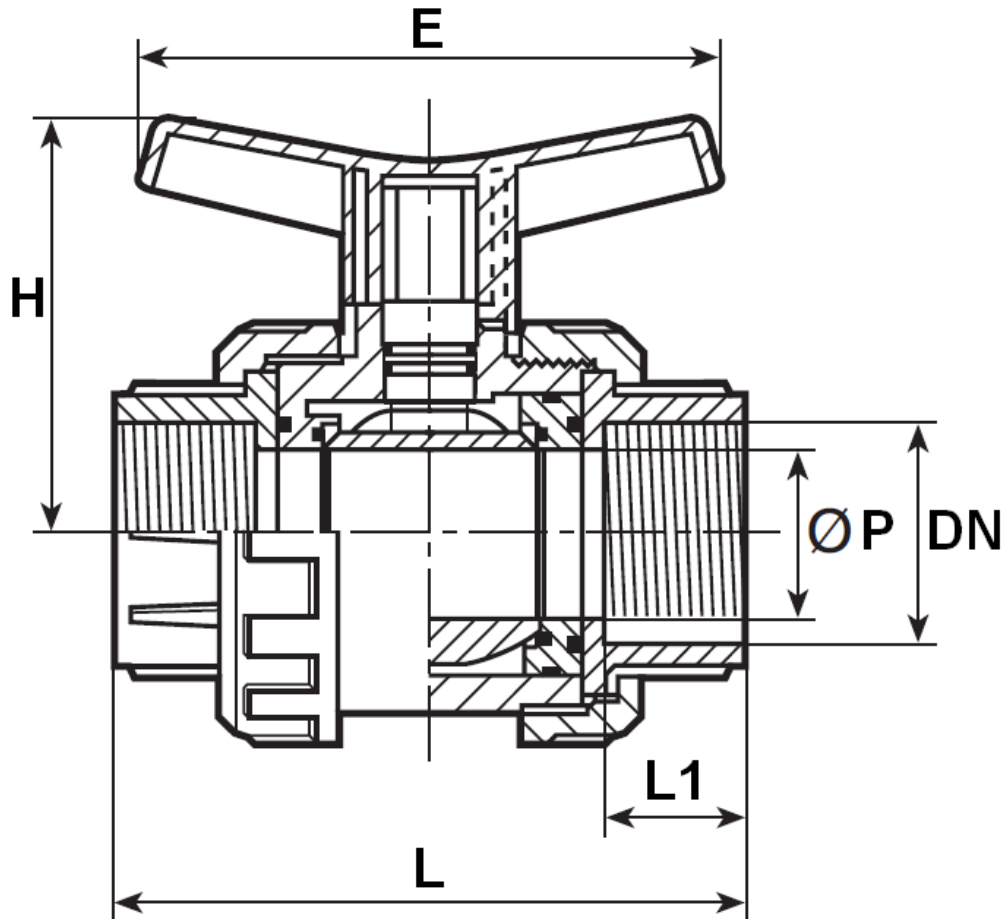

Ref.	DN	1/2"	3/4"	1"	1"1/4	1"1/2	2"
599	Ø P	15	20	25	32	40	50
	L	94.5	102	115	130	144	166
	L1	16	19	22	26	31	38
	E	85	85	99	99	128	128
	H	50.5	53	63	69	85	94
	Weight (Kg)	0.152	0.207	0.316	0.465	0.788	1.145

INDUSTRY PVC-U BALL VALVE**STANDARDS :**

- Fabrication according to ISO 9001 : 2000
- DIRECTIVE 97/23/CE : Products excluded from directive (Article 1, § 3.2)
- Size according to **EN 1452**
- Test according to **UNE EN 917**
- Threaded cylindrical female BSP ends according to ISO 228-1

ADVICE : Our opinion and our advice are not guaranteed and SFERACO shall not be liable for the consequences of damages.
The customer must check the right choice of the products with the real service conditions.

INDUSTRY PVC-U BALL VALVE

INSTALLATION INSTRUCTIONS

- . Before installing the valves, clean and remove any objects from the pipes (in particular bits of sealing and metal) which could obstruct and block the valves.

- . Ensure that both connecting pipes either side of the valve (upstream and downstream) are aligned (if they are not the valves may not work correctly).

- . Make sure that the two sections of the pipe (upstream and downstream) match , the valve unit will not absorb any gaps. Any distortions in the pipes may affect the tightness of the connection, the working of the valve and can even cause a rupture.

- . If sections of piping do not have their final support in place, they should be temporarily fixed. This is to avoid unnecessary strain on the valve.

- . The theoretical lengths given by ISO/R7 for the tapping are typically longer than required, the length of the thread should be limited use PTFE tape to ensure the tightness of the fixing, and check that the end of the tube does not press right up to the head of the thread

- . Position the pipe clips on both sides of the valve.

- . Never use a vice to tighten the fixings of the valve.

- . Use a spanner to tight the nuts of the valve. Valve nuts have to be tightened by hand onto the body and never use a metal tool. If the tightness isn't good enough, then lubricate the threads with Vaseline grease or silicone oil to achieve the required tight.

- . This valves are not prepared to work with gas and air.

- . Install the ball valve so that the arrow marked in the body indicate the same direction of the flow. Only so, can be dismantled the side of the valve without pressure when it is closed.

- . Before the two valve end connections are solvent cemented, the valve has to be dismantled, to prevent that adhesive remains reach the valve's inside, damaging it.

INDUSTRY PVC-U BALL VALVE
INSTRUCTIONS FOR SOLVENT CEMENT JOINTING :

- Pipe must be cut off at right angles..

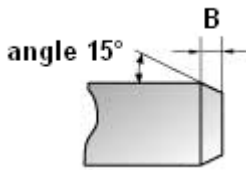

- Chamfer the tube end in form and size as illustrated :

Ø external tube	B (mm)
6 - 16 mm	1 - 2
20 - 50 mm	2 - 4
63 - 90 mm	4 - 6



- Mark the solvent cement position and clean the outside of the pipe and the inside of the socket with an absorbent paper.
- The cleaned surface should have a matt finish. Do not touch the clean surface.



- Check the correct consistency of the cement, it must run evenly from a wooden spatula held at a slant, like a thickened oil. Never use cement with grums or if it can not smoothly run.

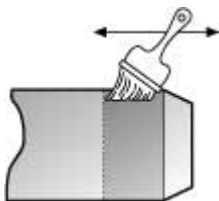

- Apply the cement to the pipe and to the fitting socket in an axial direction. Use a brush.

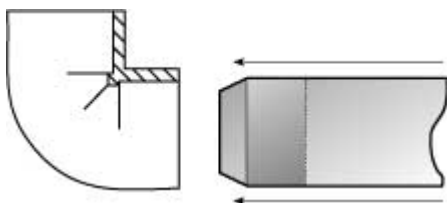

- Joint pipe and fitting without turning and before 1 minute from the cement application.
- Remove the surplus cement.
- The drying time depends of the ambient temperature.
- Here are the values by 20°C temperature :

Ø external tube	Drying time
6 - 63 mm	1 hour per bar
75 - 90 mm	2 hours per bar