

Ball Valve



**PN 16-40 / Class 150-300
DN 15-500**

Applications

- Gas lines and gas installations
- Gases to DVGW Worksheet G 260/I and II
- Combustible liquids as well as non-corrosive fluids
- Application requirements and tests according to DIN 3230 Part 5 PG 3 for gas lines and gas installations, DIN 3230 Part 6 for combustible liquids as well as API 6D and customer-specific requirements.

Operating data

- Permissible pressure: 16 to 40 bar / Class 150 – 300
- Permissible temperature -10 °C to +70 °C

Materials

- S235JR

Standard design

- DVGW type tested
- Fully welded design
- Floating ball; from DN 150: trunnion-mounted ball
- Seat rings made of PTFE
- Sealing on the downstream side in both flow directions
- Blow-out protected stem
- Lever on the stem
- Flanged

Design variants

- Polyurethane coating as corrosion and cathodic protection for underfloor installation
- Split body design
- Possible operating temperature: -60 °C to +250 °C
- With butt weld ends
- With gearbox and handwheel
- With electrical actuator or piston actuator

Additional information

- Operating instructions: 8301.81

Purchase order data

1	Type	7	Material
2	PN	8	Fluid
3	DN	9	Flow rate
4	Operating pressure	10	Pipe connection
5	Differential pressure	11	Variants
6	Operating temperature	12	Type series booklet number

Pressure/Temperature ratings

PN 165 - 40 Class 150 - 300	Steel pipe	-10 °C to 70 °C
--------------------------------	------------	-----------------

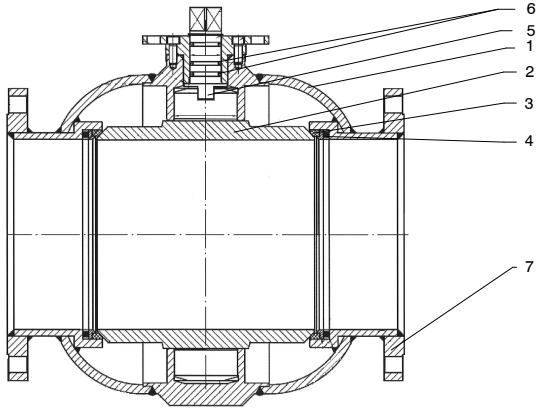

Materials

Part No.	Description	Materials
1	Body	S235JRGZ
2	Ball	X6CrNiTi18-10 *)
3	Seat ring	PTFE
4	Thrust ring	S235JR
5	Stem	X20Cr13
6	Stem O-rings	NBR
7	Flange	S235JRGZ
8	Lever/Handwheel	Steel

*) Chrome-plated or stainless steel

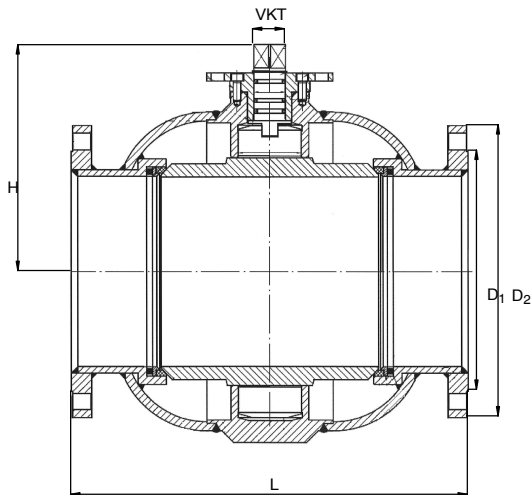
Connecting dimensions

Dimensions

DN	PN	D1	D2	H	L	VKT
mm	bar			mm		
15	16 - 40	47	95	57	115	-
20	16 - 40	58	105	65	120	-
25	16 - 40	68	115	70	125	-
32	16 - 40	78	140	58	130	-
40	16 - 40	88	150	90	140	-
50	16 - 40	102	165	108	150	17
65	16	122	185	116	170	17
	25-40	122	185			
80	16	133	200	131	180	22
	25-40	133	200			
100	16	158	220	148	190	22
	25-40	158	235			
125	16	184	250	160	325	22
	25-40	184	270			
150	16	212	285	200	350	27
	25-40	212	300			
200	16	268	340	237	400	27
	25	278	360			
	40	285	375			
250 *)	16	320	405	328	450	-
	25	355	425			
300 *)	16	370	460	355	500	-
	25	390	485			
400 *)	16	482	580	500	762	-
	25	505	620			
500 *)	16	585	715	600	914	-
	25	615	730			

*) With gearbox and handwheel

