

**Ball valve,  
metal-seated**



**PN 10-250 / Class 150-1500  
DN 15-500**

## Applications

- Gas lines and gas installations
- Gases to DVGW Worksheet G 260/I and II
- Combustible liquids as well as non-corrosive fluids
- Application requirements and tests according to DIN 3230 Part 5 PG 3 for gas lines and gas installations, DIN 3230 Part 6 for combustible liquids as well as API 6D and customer-specific requirements.

## Operating data

- Permissible pressure: 10 to 250 bar / Class 150 - 1500
- Permissible temperature -10 °C to +70 °C

## Materials

- P355NL1 1.0566

## Standard design

- Split body design (bolted)
- All-metal seat rings
- Trunnion-mounted ball
- Blow-out protected stem
- With gearbox and lever mounted on the stem
- Anti-static design

## Design variants

- Other materials on request
- Possible operating temperature: -60 °C to +250 °C
- With flanges or butt weld ends
- Available with electrical and pneumatic actuators

## Additional information

- This model cannot be dismantled if welded into a pipe.
- Operating instructions: 8301.81

## Purchase order data

- |   |                       |    |                            |
|---|-----------------------|----|----------------------------|
| 1 | Type                  | 7  | Material                   |
| 2 | PN                    | 8  | Fluid                      |
| 3 | DN                    | 9  | Flow rate                  |
| 4 | Operating pressure    | 10 | Pipe connection            |
| 5 | Differential pressure | 11 | Variants                   |
| 6 | Operating temperature | 12 | Type series booklet number |

**Pressure/Temperature ratings**

PN 10 - 250 Class 150 - 1500	Steel pipe	-10 °C to +70 °C
---------------------------------	------------	------------------

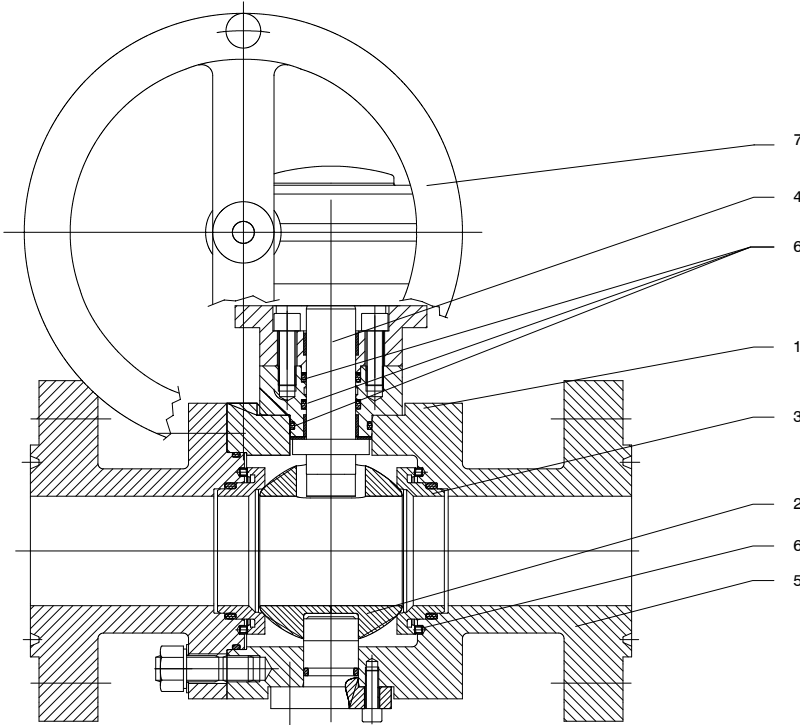

**Materials**

Part No.	Description	Materials
1	Split body	P355NL1 1.0566
2	Ball	P265GH *) 1.0425
3	Metal seat rings	P265GH *) 1.0425
4	Stem	42 CrMo 4 1.7225
5	Flanges	P355NL1 1.0566
6	O-rings	FPM
7	Handwheel	Steel

\*) Tungsten carbide coated

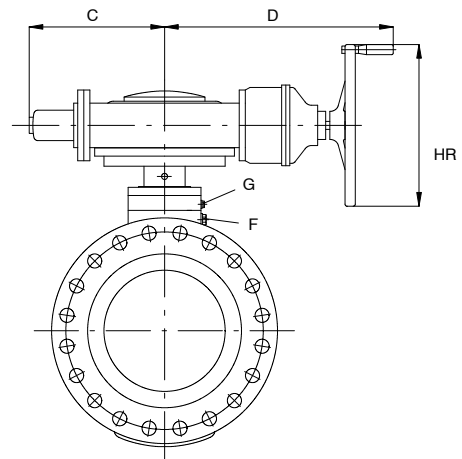
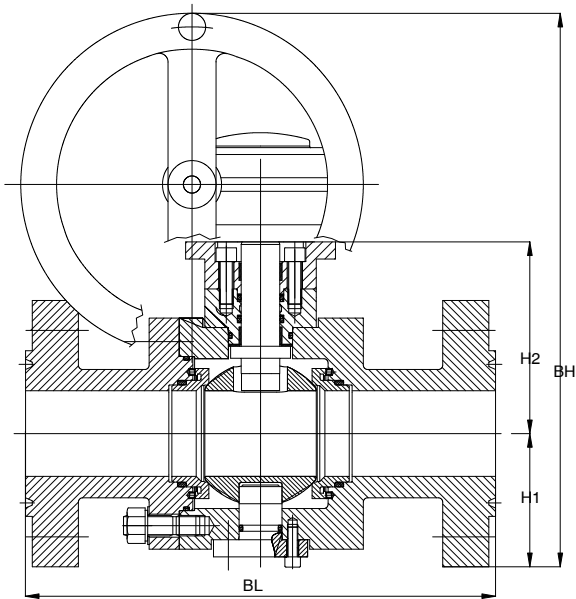
**Connecting dimensions**

**Dimensions**

DN	PN/Class	C	D	F	G	H1	H2	BL			BH	∅ HR	Da	s	Weight
								FL-RF	FL-RTJ	AE/WE					
50/2"	250/1500	133	170	-	1/4"	95	145	368	371	368	350	160	60.3	6.3	70
80/3"	250/1500	133	170	-	1/4"	132	176	470	473	470	415	160	88.9	7.1	170
100/4"	250/1500	133	170	-	1/4"	135	195	546	549	546	475	200	114.3	7.9	270
150/6"	250/1500	195	200	1/2"	1/4"	265	345	705	711	705	755	200	168.3	8.7	600
200/8"	250/1500	340	450	1/2"	1/4"	305	360	832	841	832	825	250	219.1	9.5	1100
250/10"	250/1500	340	450	1/2"	1/4"	360	425	991	1000	991	950	250	273.1	11.0	1665
300/12"	250/1500	400	545	1/2"	1/4"	400	445	1130	1146	1130	1055	315	323.9	12.7	2400
350/14"	250/1500	400	545	1/2"	1/4"	450	580	1257	1276	1257	1330	315	355.8	14.3	3260
400/16"	250/1500	490	627	1/2"	1/4"	550	790	1384	1407	1384	1610	400	406.4	15.9	4250
450/18"	250/1500	On request													
500/20"	250/1500														

