

CAST STEEL CHECK VALVE

Ref. 373/374

Ref. : DS 373

Rev. : 2

Date : 11/07

Page 1/2



Valves and fittings

90 rue du ruisseau 38297 ST QUENTIN FALLAVIER
Tel : (33)04.74.94.15.90 Fax : (33)04.74.95.62.08
E.mail : sferaco@sferaco.fr

SPECIFICATIONS :

- . Swing check type
- . Flanged ASA150 or ASA300
- . Cast steel
- . Full opening
- . 1/2 stellite (trim 8)
- . Aluminium painting
- . Horizontal or vertical position

USE FOR ASA150 VERSION:

- . Water distribution, gas oil, petrochimie, steam ...
- . Min/Max Temperature Ts : -29°C +425°C
- . Max. pressure Ps : 20 bars

USE FOR ASA300 VERSION :

- . Water distribution, gas oil, petrochimie, steam ...
- . Min/Max Temperature Ts : -29°C +425°C
- . Max. pressure Ps : 50 bars



RANGE :

- . Flanged ASA150 **Ref. 373** DN50 to DN300 , flanged R.F stock finish Ra=3,2-6,3 µm
- . Flanged ASA300 on demand **Ref.374** DN50 to DN300 , flanged R.F stock finish Ra=3,2-6,3 µm

MATERIALS :

N°	DESIGNATION	MATERIALS
1	Body	A216 WCB
2	Seat	A105 + STL6
3	Disc	WCB + 410
4	Washer	410
5	Disc nut	410
8	Stem	410
11	Cover gasket	Graphite/Stainless steel
12	Cover	A216 WCB
13	Stud bolt	B7
14	Nut	ZH
15	Eyebolt	1025

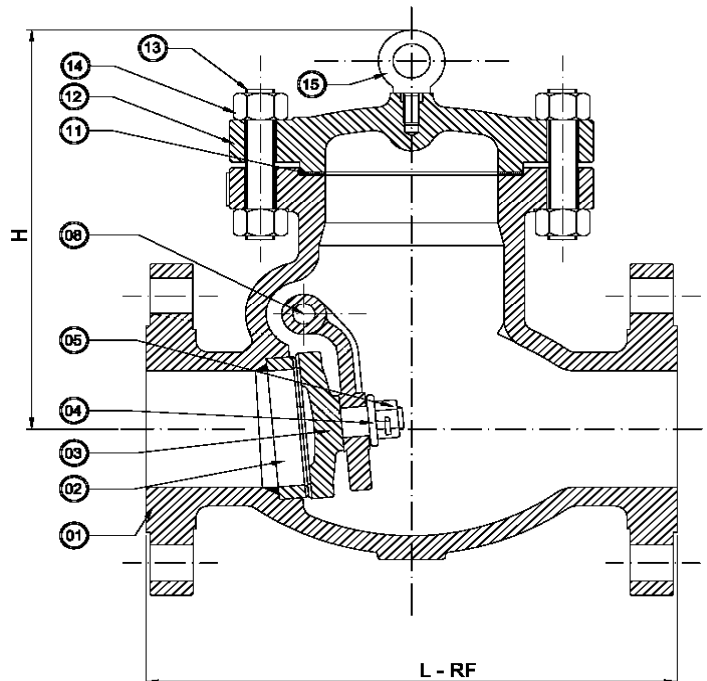

N.B. : Please remove the disc hold before use

CAST STEEL CHECK VALVE

Ref. 373/374

Ref. : DS 373

Rev. : 2

Date : 11/07

Page 2/2



Valves and fittings

90 rue du ruisseau 38297 ST QUENTIN FALLAVIER
Tel : (33)04.74.94.15.90 Fax : (33)04.74.95.62.08
E.mail : sferaco@sferaco.fr

SIZE FOR ASA150 VERSION :

	DN	50	65	80	100	150	200	250	300
Ref. 373	L	203,2	216,0	241,3	292,1	355,6	495,3	622,3	698,5
	H	146	160	172	209	312	363	444	519
	Weight	19	22	29	49	76	140	207	330

SIZE FOR ASA300 VERSION :

	DN	50	65	80	100	150	200	250	300
Ref. 374	L	266,7	292,1	317,5	355,6	444,5	533,4	622,3	711,2
	H	178	190	231	268	328	406	460	550
	Weight	24	33	44	75	124	188	325	475

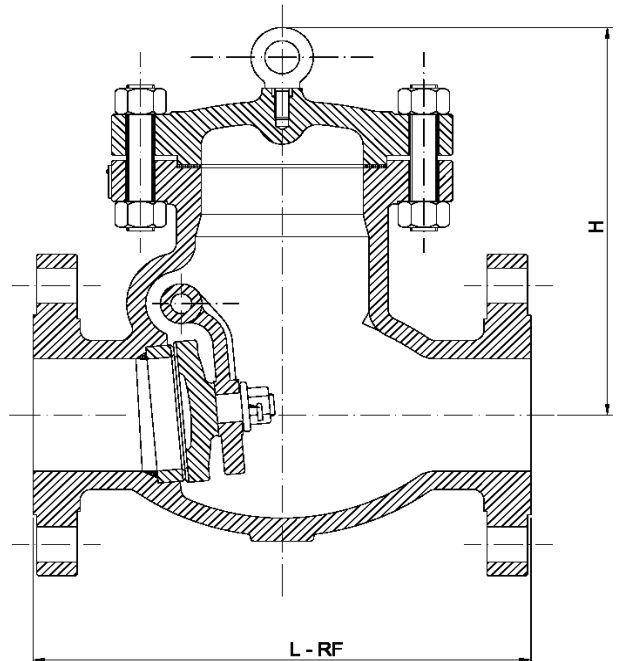

RELATION PRESSURE/TEMPERATURE FOR ASA150 VERSION :

Pres. (bar)	19,6	19,2	17,7	15,8	14	12,1	10,2	8,4	6,5	5,6
Temp. (°C)	38	50	100	150	200	250	300	350	400	425

RELATION PRESSURE/TEMPERATURE FOR ASA300 VERSION :

Pres. (bar)	51,1	50,1	46,4	45,2	43,8	41,7	38,7	37	34,5	28,8
Temp. (°C)	38	50	100	150	200	250	300	350	400	425

STANDARDS :

- . According to BS 1868 ANSI B16.34
- . Length according to ANSI B16.10
- . DIRECTIVE 97/23/CE : N° CE 0062
Risk category III Module H1
- . ATEX 94/9/EC (group II Category 2)
- . Test according to API 598

ADVICE : Our opinion and our advice are not guaranteed and SFERACO shall not be liable for the consequences of damages. The customer must check the right choice of the products with the real service conditions.