

CARBON STEEL GLOBE VALVE WITH BELLOW PN40



ISO 9001
BUREAU VERITAS
Certification



Size : DN 15 to DN 200
Ends : ISO R.F.PN25/40 Flanges
Min Temperature : - 20°C
Max Temperature : + 400°C
Max Pressure : 40 Bars
Specifications : Rising rotating stem and handwheel
Bolted bonnet and gland pack
Stainless steel bellow

Materials : Carbon steel

CARBON STEEL GLOBE VALVE WITH BELLOW PN40
SPECIFICATIONS :

- Respect the flow direction indicated by the arrow
- Rising rotating stem and handwheel
- Bolted bonnet and gland pack
- Stainless steel bellow
- ISO PN25/40 Flanges R.F.
- Blue painting RAL 5002

USE :

- Common fluids of 2nd group , steam , thermic fluid
- Min and max Temperature Ts : - 20°C to + 400°C
- Max Pressure PN : 40 bars (see graph)
- Keep greased the stem

FLOW COEFFICIENT Kv (M3 / h) :

DN	15	20	25	32	40	50	65	80	100	125	150	200
Kv (m3/h)	4.3	7	11	17.5	27	47	68	116	162	250	364	570

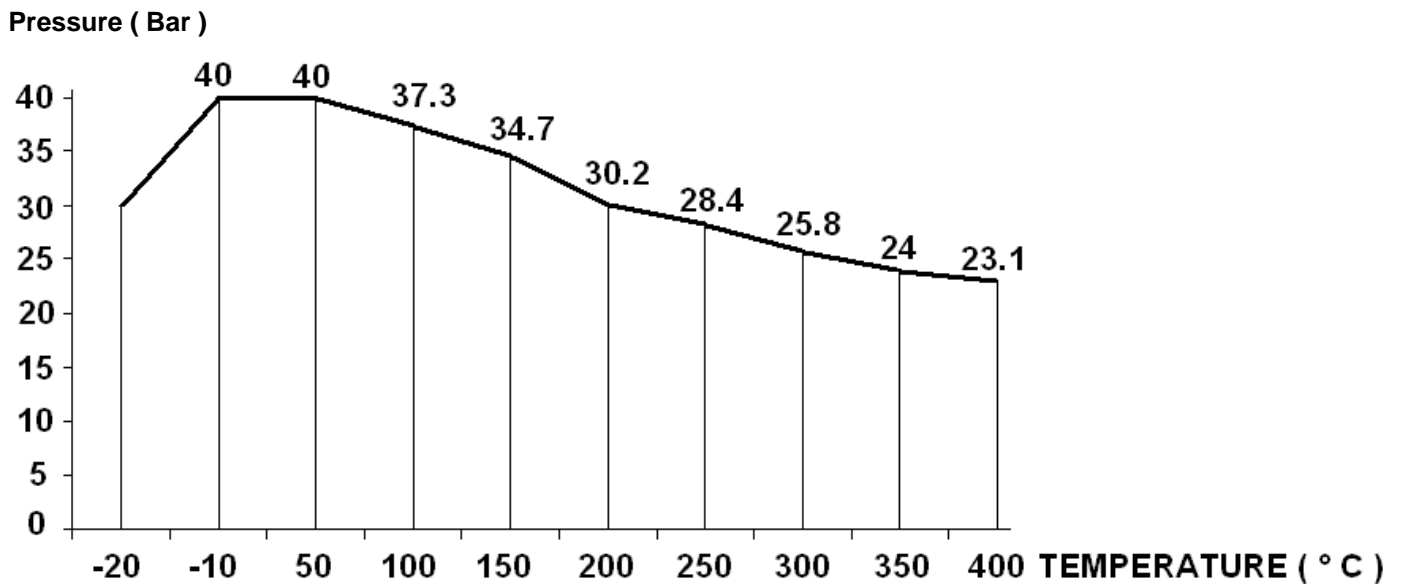
PRESSURE / TEMPERATURE GRAPH :

RANGE :

- Stainless steel bellow and Carbon steel body flanged R.F. ISO PN25/40 from DN 15 to DN 150 and ISO PN40 for DN200 **Ref. 475**

CARBON STEEL GLOBE VALVE WITH BELLOW PN40

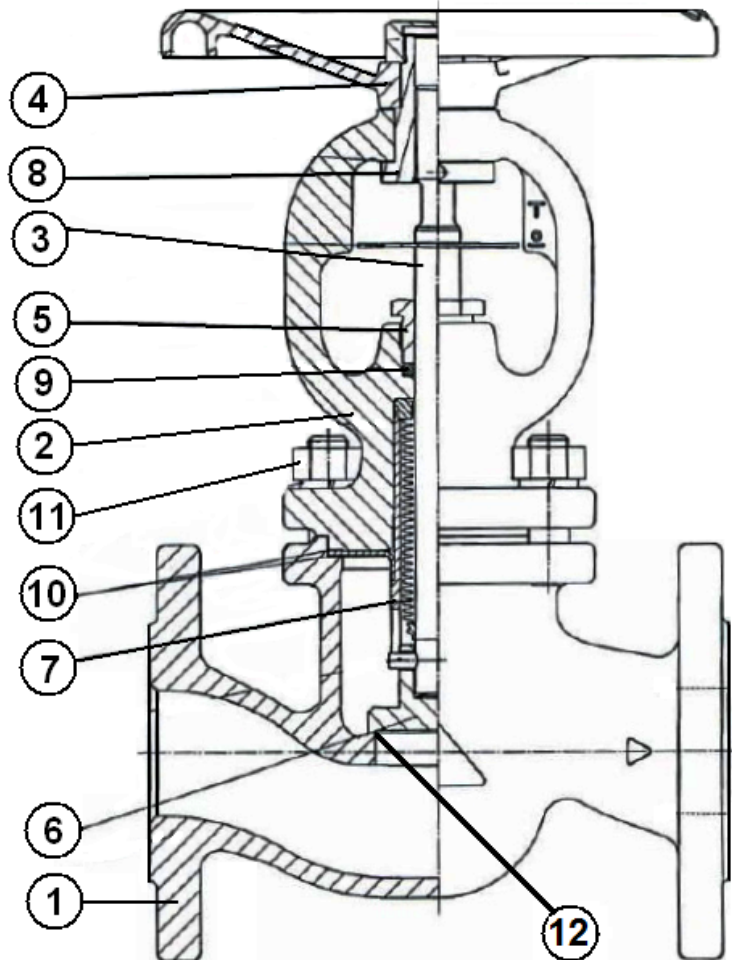
MATERIALS :



Item	Designation	Materials
1	Body	A216 WCB (1.0619)
2	Bonnet	A216 WCB (1.0619)
3	Stem	SS 303 (1.4305)
4	Handwheel	Cast iron
5	Gland	11SMnPb30 (1.0718)
6	Disc	SS 420 (1.4021)
7	Bellow	SS 321 (1.4541)
8	Ring	11SMnPb30 (1.0718)
9	Gland packing	Graphite
10	Bonnet gasket	Graphite + CrNiSt
11	Bolt and nut	A2-70
12	Seat	SS 410 (1.4006)

CARBON STEEL GLOBE VALVE WITH BELLOW PN40

SIZE (in mm) :

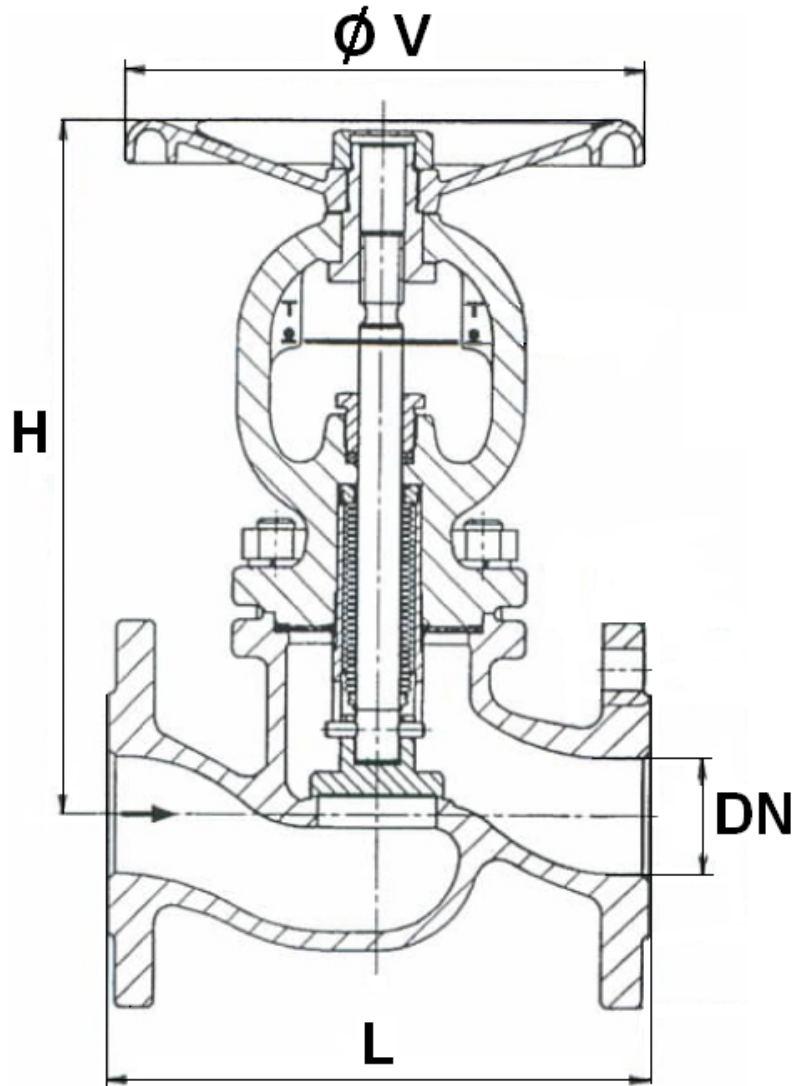

REF.	DN	15	20	25	32	40	50	65	80	100	125	150	200
475	L	130	150	160	180	200	230	290	310	350	400	480	600
	H (closed)	189	189	189	220	220	295	295	368	368	523	523	670
	H (opened)	195	195	195	230	230	311.5	311.5	393	393	563	563	720
	Ø V	120	120	120	160	160	195	195	280	280	350	350	400
	Weight (Kg)	4.7	5.5	6.17	11.25	12.49	15.45	20.5	34	44	77	110	205

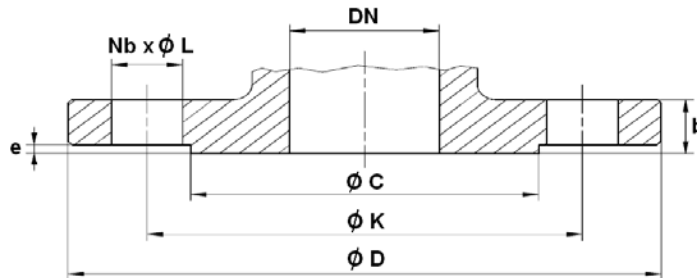
CARBON STEEL GLOBE VALVE WITH BELLOW PN40
FLANGES SIZE (in mm) :

DN	15	20	25	32	40	50	65	80	100	125	150	200
Ø C	45	58	68	78	88	102	122	138	162	188	218	285
Ø D	95	105	115	140	150	165	185	200	235	270	300	375
Ø K	65	75	85	100	110	125	145	160	190	220	250	320
Nb x Ø L	4 x 14	4 x 14	4 x 14	4 x 18	4 x 18	4 x 18	8 x 18	8 x 18	8 x 22	8 x 26	8 x 26	12 x 30
b	16	18	18	18	18	20	22	24	24	26	28	34
e	2	2	2	2	3	3	3	3	3	3	3	3

STANDARDS :

- Fabrication according to ISO 9001 :2008
- DIRECTIVE 97/23/CE : CE N° 0062
Risk category III module H
- Tests according to EN 12266-1, leakproofness class A
- Length according to EN 558-1 series 1 (DIN 3202 F1)
- Flanges R.F. according to EN 1092-1 PN40
- Approval certificate Russian Federation **GOST-R**
- Approval certificate Polish **PZH**

ADVICE : Our opinion and our advice are not guaranteed and SFERACO shall not be liable for the consequences of damages. The customer must check the right choice of the products with the real service conditions.

CARBON STEEL GLOBE VALVE WITH BELLOW PN40

INSTALLATION INSTRUCTIONS

GENERAL GUIDELINES :

- Ensure that the valves to be used are appropriate for the conditions of the installation (type of fluid, pressure and temperature).
- Be sure to have enough valves to be able to isolate the sections of piping as well as the appropriate equipment for maintenance and repair.
- Ensure that the valves to be installed are of correct strength to be able to support the capacity of their usage.
- **Installation of all circuits should ensure that their function can be automatically tested on a regular basis (at least two times a year).**

INSTALLATION INSTRUCTIONS :

- **Before installing the valves, clean and remove any objects from the pipes** (in particular bits of sealing and metal) which could obstruct and block the valves.
- **Ensure that both connecting pipes either side of the valve (upstream and downstream) are aligned (if they're not, the valves may not work correctly).**
- **Make sure that the two sections of the pipe (upstream and downstream) match, the valve unit will not absorb any gaps. Any distortions in the pipes may affect the tightness of the connection, the working of the valve and can even cause a rupture.** To be sure, place the kit in position to ensure the assembling will work.
- **If sections of piping do not have their final support in place, they should be temporarily fixed. This is to avoid unnecessary strain on the valve.**
- Tighten the bolts in cross.
- It's recommended to operate the valve (open and close) 1 to 2 times per year
- Tighten the gland packing at the first start of the installation (with a moderate torque) so that there's no leakage and the handwheel is easy to operate.
- Do not use tools to operate the handwheel
- Respect the flow direction indicated by the arrow