

REGULATION ELECTRIC ACTUATOR SA05PCU

GENERAL CHARACTERISTICS

The SA05PCU electric actuator is used on ¼ turn valves. The maximum output torque is 50 Nm. Its compact construction with an epoxy coated aluminium enclosure (protection IP 67) makes it convenient for actuation on ball valves and butterfly valves. 3-point actuator. Proportional regulation 4-20 mA.

IP 67



LIMITS OF USE

Protection rating	IP 67
Temperature range	-20 °C / +70 °C
Service	S2-70%

MECHANICAL CHARACTERISTICS

Gears	Steel
Torque	50 Nm
Manual override	6 mm Allen key
ISO 5211 pad	Star drive nut 14
Position indicator	LED (opening and closing)
Torque limiter	Mechanical end stops



ELECTRICAL CHARACTERISTICS

Motor protection	Thermal cut-out	Anti-condensation	2 W heater
Limit switch	2 adjustable switches	Electrical connection	2 Gland packs M20x1.5 (not supplied)
Auxiliary limit switch	2 auxiliary dry switches	Cutting capacity	250 V 3 A max.
Input	0-10 V DC; 4-20 mA	Feedback output	0-10 V DC; 2-10 V DC; 0-20 mA; 4-20 mA

OPTIONS

110 V, local control

CONSTRUCTION

Enclosure	Epoxy coated aluminium
Cover	Epoxy coated aluminium
Gears, Stem, Cams	Steel

The following data is for information purpose only and may be subject to alteration without prior notice

	SECTORIEL S.A. 45, rue du Ruisseau 38290 Saint Quentin-Fallavier – FRANCE Tel.: +33 474 94 90 70 – Fax: +33 474 94 13 95 www.sectoriel.fr / email: sectoriel@sectoriel.fr	Pages	1/2
	Ref.	FT23050 GB	
	Rev.	2	
	Date	09/2007	

REGULATION ELECTRIC ACTUATOR SA05PCU

DIMENSIONS (mm)

Item	A	B	C	D	E	F
SA05PCU	132	208	44	194	168	72

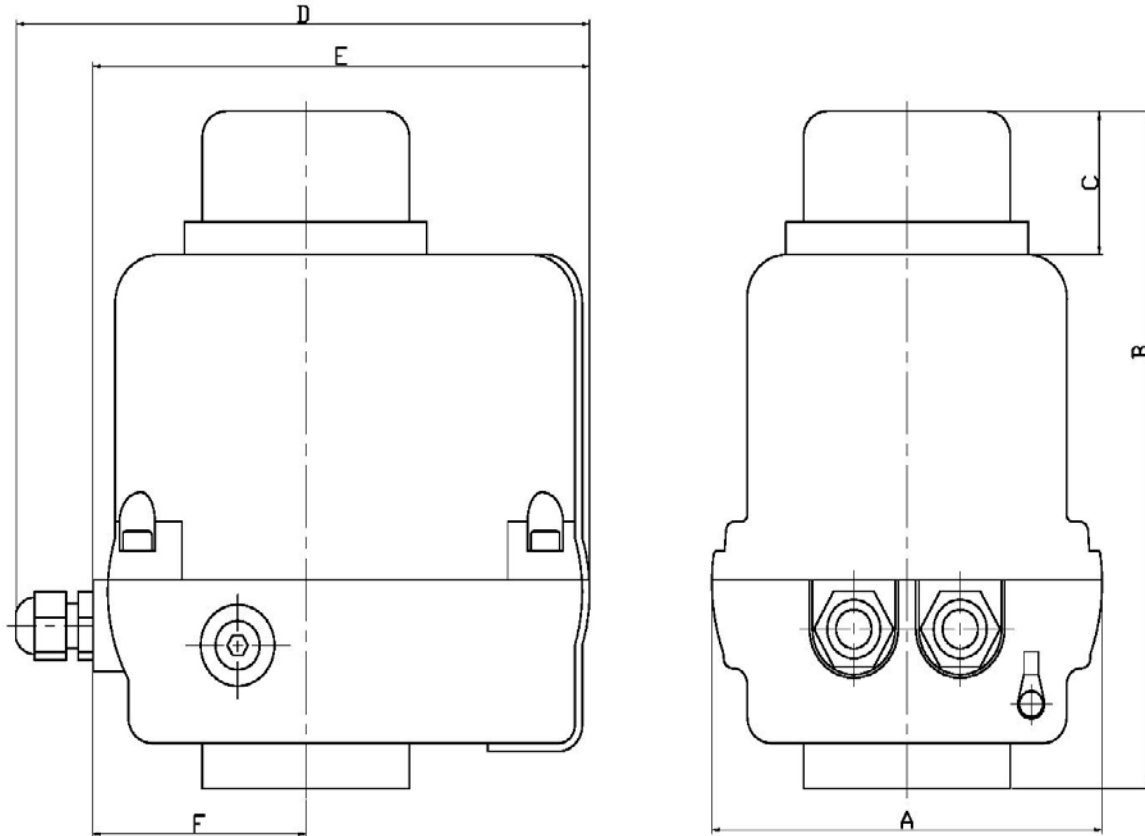

OTHER CHARACTERISTICS

Electric actuator	SA05PCU	SA05PCU
Voltage	230 V AC	24 V DC
Power	6 W	6 W
Torque	50 Nm	50 Nm
Operating time	17 s	17 s
ISO 5211 pad	F03/F05/F07	F03/F05/F07
Star drive nut	14 mm	14 mm

INSTALLATION, MAINTENANCE AND ADJUSTMENTS

See Operation and Maintenance Instruction Manual #IME23011

The following data is for information purpose only and may be subject to alteration without prior notice

	SECTORIEL S.A. 45, rue du Ruisseau 38290 Saint Quentin-Fallavier – FRANCE Tel.: +33 474 94 90 70 – Fax: +33 474 94 13 95 www.sectoriel.fr / email: sectoriel@sectoriel.fr	Pages	2/2
		Ref.	FT23050 GB
		Rev.	2
		Date	09/2007