

STAINLESS STEEL SIGHT GLASS SKB 2

MAIN CHARACTERISTICS

The SKB2 sight glass is dedicated to the visual control of flow in stainless steel pipes. With the full stainless steel construction, the SKB2 is mainly used for applications in chemical processes. The SK2 has a double windows construction and is fitted with a stainless steel moving flapper for the control of transparent fluids.

AVAILABLE MODELS

Sizes from DN15 to DN200

Flanged PN16 RF connections

CLASSIFICATION FOLLOWING PED 97/23

Homologation CE 0035 category II.

LIMITS OF USE

PS : 16 bar

TS : -10°C / +180°C

CONSTRUCTION

Body	Stainless steel ASTM A351 CF8M
Flanges	Stainless steel ASTM A351 CF8M
Bolt	Stainless steel AISI 304
Flapper	Stainless steel ASTM A351 CF8M
Glass gasket	PTFE
Glass	Tempered glass

DIMENSIONS (mm)

Size	15	20	25	32	40	50	65	80	100	125	150
L	130	150	160	180	200	230	290	310	350	400	480
H	100	100	100	125	125	125	167	180	210	270	280
D	40	40	40	50	50	50	85	85	110	130	160

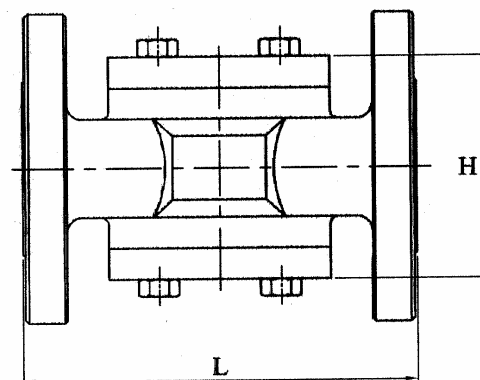
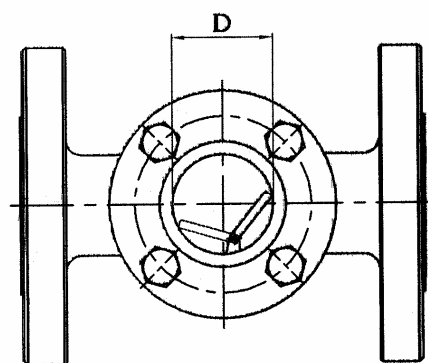

Modifications reserved

STAINLESS STEEL SIGHT GLASS SKB 2

INSTALLING AND MAINTAINING

- Before installation or maintaining, shut off the line using upstream and downstream valves.
- Remove the pressure inside and drain the pipe.
- If the pipe is warm, wait the complete cooling to room temperature.
- Wear protections equipments adapted to this kind of operation (gloves and glasses).

Installing

- Decide the position of the sight glass on the line in order to make it visible for the operators.
- Choose flanges gaskets adapted to the fluid.
- Install the sight glass between the flanges, taking into account the arrow stamped on the body. This arrow must follow the direction of the flow.
- Screw the bolts of the flanges.

Maintaining

- Remove the two glass flange and remove the glasses.
- Clean the glasses, the flapper and the inner part of the body.
- Verify the state of the glass and check any starting of chemical corrosion or mechanical erosion. Replace it if necessary.

SPARE PARTS

Spare parts kits including 1 glass and 1 gasket.

Size	Ordering Code
15 – 25	981077
32 – 50	981078
65 – 80	981079
100	981080
125	981081
150	981082

Modifications reserved